



T-KIT Switchmatic

Electronic pressure switch + 3 ways fitting + non-return valve + complet pump protection. Patented Model.

T-KIT Switchmatic is an electronic pressure switch integrated in a 3-ways fitting with a digital pressure gauge. It can manage the start and stop of single-phase electric pumps up to 3 HP (2,2 kW). Cut-in and cut-out pressure implementation can be set easily and accurately through a users friendly control panel. Wiring is carried out identically to a conventional electromechanical switch.

It can operate as a differential pressure switch and as an inverted pressure switch.

There is an internal non-return valve.

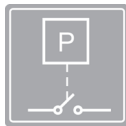

T-KIT Switchmatic 1

OPERATING CHARACTERISTICS

- Electronic pressure switch integrated in a 3 ways fitting.
- Inner non-return valve.
- Sleep mode with low power consumption.
- Inner pressure transmitter.
- Integrated pressure gauge with bar and psi instantaneous display.
- User friendly control panel with 3-digits display, led-lights and pushbuttons.
- Dry-running protection for minimal pressure.
- **ART function** (Automatic Reset Test). If the device has been stoped due the action of the safety system against dry operation, the ART tries to connect the pump, with a programmed periodicity because the water supply could have been restored.
- Rapid-cycle alarm: when the hydropneumatic tank has lost the air and frequent start-stops are produced an alarm is activated and is delayed the start.
- Manual start.
- Advanced MENU with complementary settings.
- **Register of operational parameters.** Information about: operating hours, counter of starts, counter of connections to the power supply.
- **Register of alarms.** Information about type and number of alarms.



Low Voltage Directive 2014/35/EC
Electromagnetic Compatibility 2014/30/EC
RoHS 2011/65/EC + 2015/863/EC



CONTROL PANEL

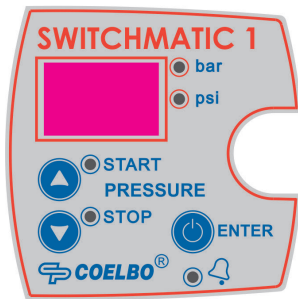

- 3 digits display:
 - Operating mode: Instantaneous pressure.
 - Set mode: Cut in and cut out pressure.
 - Bar-psi led lights (green):
 - Operating mode: Bright bar or psi.
 - Pump on: Flashing bar or psi.
 - Star-Stop Led (green):
 - Bright: displayed Pressure start or Pressure stop.
 - Flashing: Setting Pstart or Pstop.
 - Push Buttons ▼▲: Increase or decrease configuration parameters.
 - ENTER push-button:
 - Manual start and stop.
 - Confirm configuration value.
 - Alarm red light 🔔: dry-run and fast cycling.
- “A” push-button: Set and display current intensity.

TECHNICAL CHARACTERISTICS

	T-KIT Switchmatic 1
Power supply voltage	~1 x 110-230 Vac
Frequency	50/60 Hz
Max. current	16 A
Maximum pump power	2,2 kW (3 HP)
Starting pressure range (cut-in)	0,5 ÷ 11,5 bar
Stop pressure range (cut-out)	1 ÷ 12 bar
Maximum differential	11,5 bar
Minimum differential	0,3 bar (SW1) 0,5 bar (SW2)
Factory setting (cut-in/cut-out)	3 / 4 bar
Protection degree	IP55
Max. water temperature	40 °C
Max. environment temperature	50 °C
Net weight (without cables)	0,6 kg
Inlet thread	G 1" M
Outlet thread	G 1" F
Pneumatic tank thread	G 1" F

DIMENSIONS AND INSTALLATION

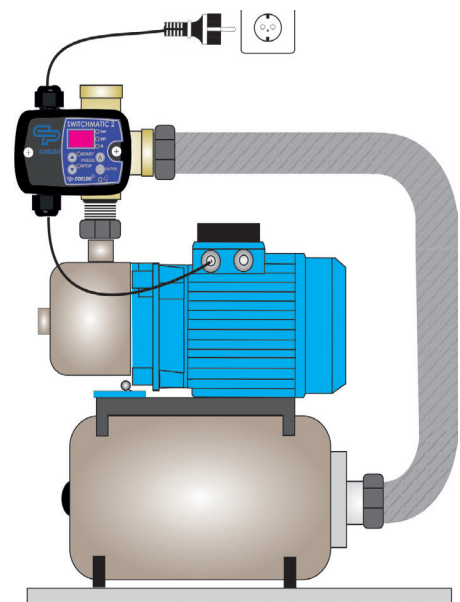
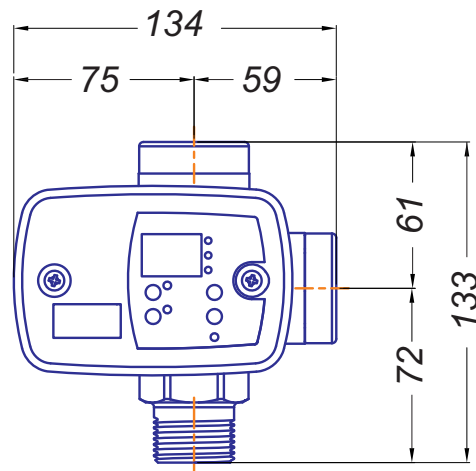
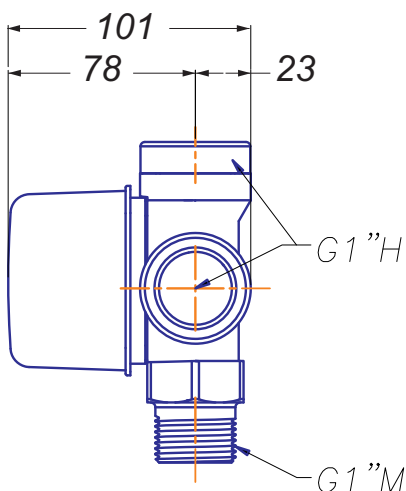



Gol Pumps Technology Company
Supply, Import, Export Water Pumps

Gol Pumps Technology

www.golpumps.com

Our Address: 6520 NW 77th CT, Miami FL 33166, USA

Sales DPT: +1 786 615 8984

After Sales Service: +1 786 452 9775

Fax: +1 786 615 7043

Email: info@golpumps.com

